



# Cubicle Installation Guide



## Sydney

[www.washroomcubicles.co.uk](http://www.washroomcubicles.co.uk)

# Cubicle Installation Guide



## Sydney®

A lively and fun way to introduce young children to toilet cubicles and the washroom environment.

Secure floor supports deliver a sturdy and safe cubicle system suited for any nursery / infant school washroom.

## Melamine Faced Chipboard

Melamine Faced Chipboard incorporates a decorative melamine surfaces bonded to both sides of high density chipboard under high pressure and temperature.

All visible MFC panels have impact resistant, PVC edging applied.

MFC is a cost effective, hygienic and lightweight solution for all non-wet toilet areas.

or

## Compact Grade Laminate

Constructed from multiple layers of high quality kraft paper, reinforced by thermosetting resins under high pressure and temperature. This produces tough, high density, totally waterproof and hygienic panels that have a high level of strength.

All visible CGL panel edges are machined to a smooth, rounded profile. CGL is the ideal choice for washrooms with high traffic.

## IMPORTANT INFORMATION

**BEFORE** you start, please ensure you have the correct number and type of panels and fittings. This product is supplied on a made-to-measure basis. Therefore the quantity of panels and fittings will vary for each job. Refer to the drawing and cutting list provided for the details of your order.

Liability is limited to replacement of components due to manufacturing defect, and only if notified to us within **3 working days** of delivery.

### Before beginning installation:

- Read through these instructions in their entirety to familiarise yourself with the process.
- We recommend a team of experienced joiners install the cubicles.
- Safety procedures must be followed at all times.
- Make sure you have the correct tools needed.
- Check that the walls and floor are level and suitable for drilling into to secure the panels.
- Check the drawing and cutting list provided to make sure you have all the hardware needed.

## YOU WILL NEED



Spirit Level



Drill



Pencil



Screw Driver

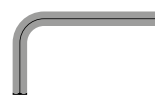

Allen Key (5mm)

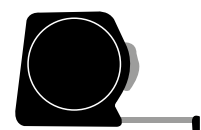

Tape Measure

# HARDWARE

**Please Note:** This product is supplied on a made-to-measure basis. Therefore the quantity of panels and fittings will vary for each job.

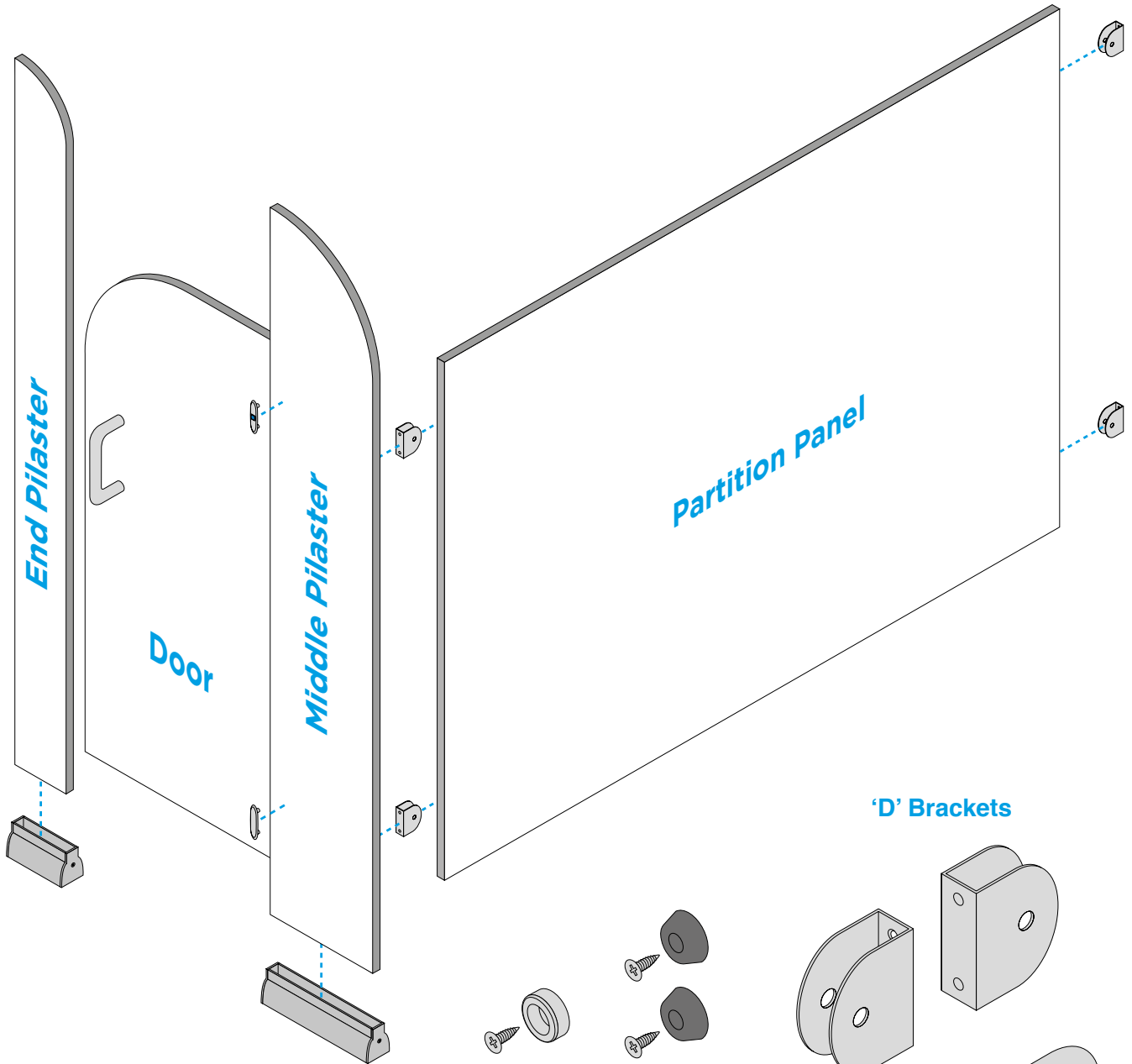

Hidden Safety Hinge

Floor Supports

Child-Friendly Handle

1

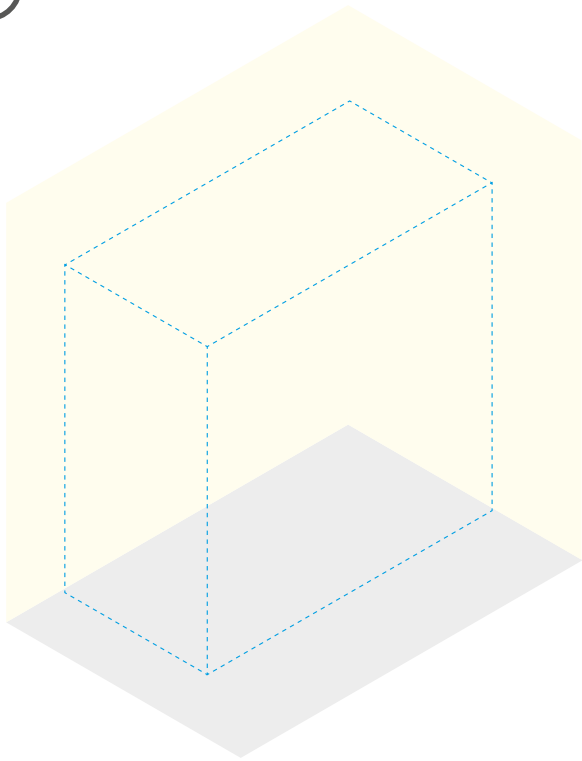

Mark out the centre lines of each panel. Ensure all verticals are plumb and horizontals are level. Make sure the walls and floors are suitable for drilling into.

2

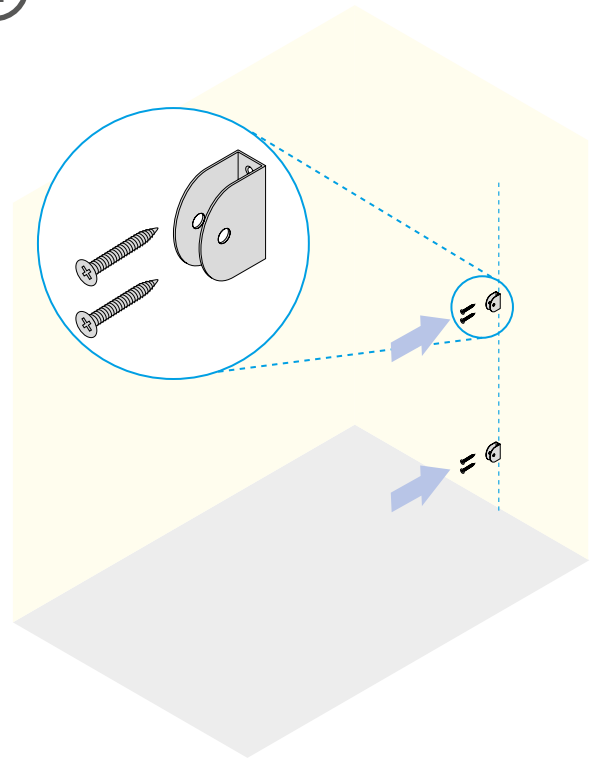

Attach two 'D' brackets to the wall using screws and wall plugs. Space the brackets evenly.

3

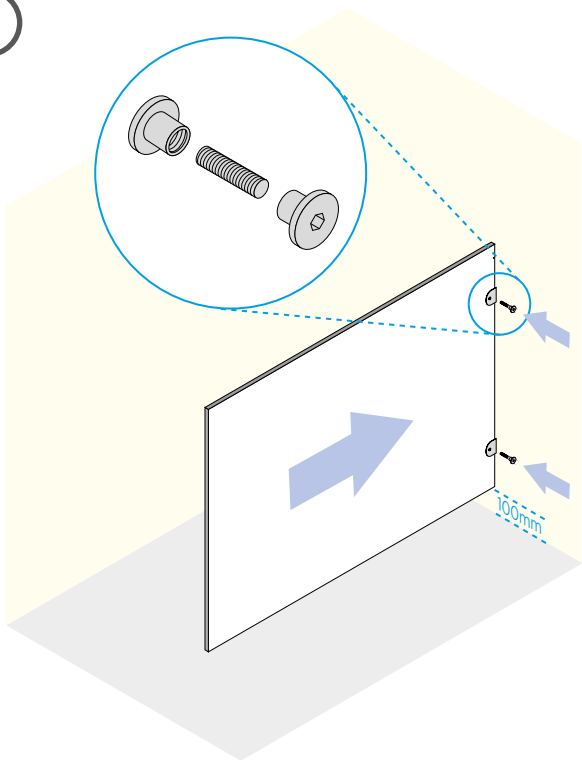

Place the partition between the brackets 100mm above floor level (as standard). Drill through the partition and secure with T-nuts.

4

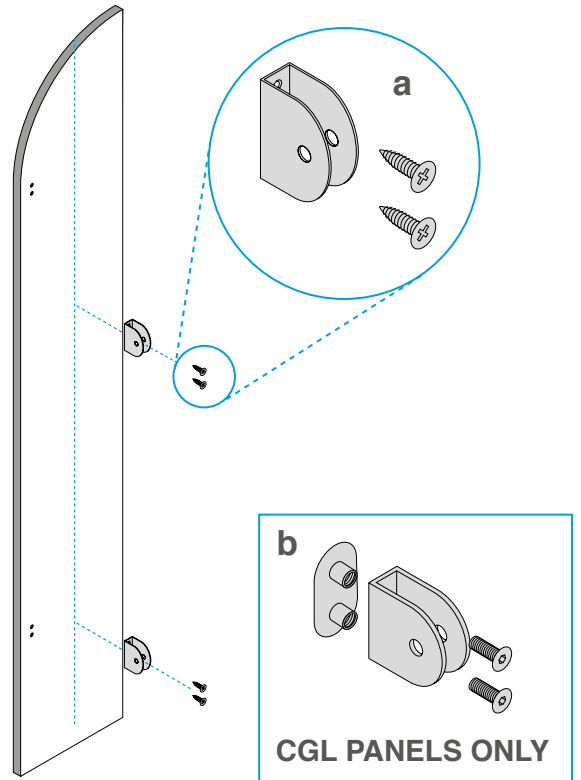

a) For MFC panels attach two brackets to the Middle Pilaster (or to the side of an end pilaster if the last cubicle).  
b) If CGL panels, drill through and attach the pilaster brackets shown in diagram (b).

5

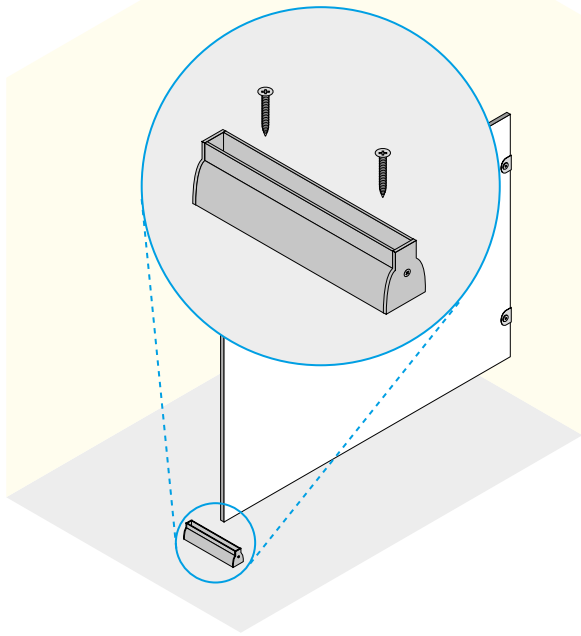

Measure and attach the floor channel to the floor using screws (not supplied).

6

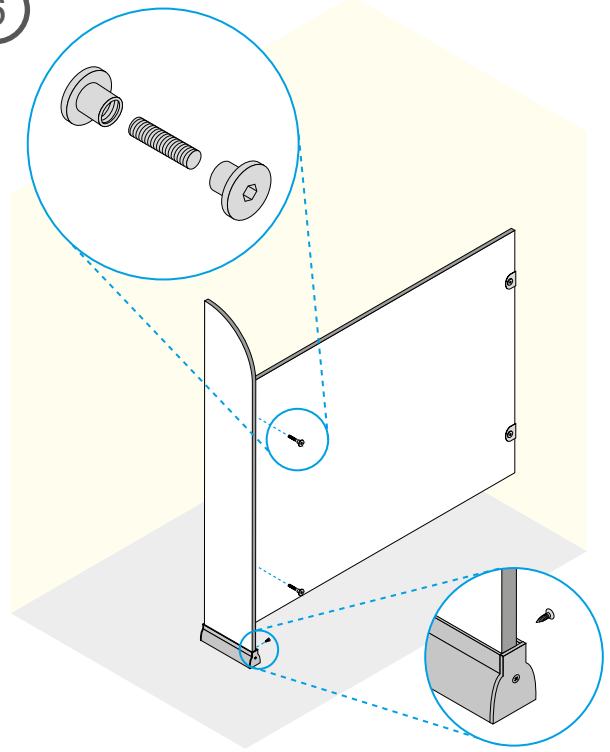

Drill through the partition and secure the pilaster with T-nuts through the 'D' brackets. Secure the pilaster into the channel by screwing through the aluminium into the pilaster with dome-head screws.

7

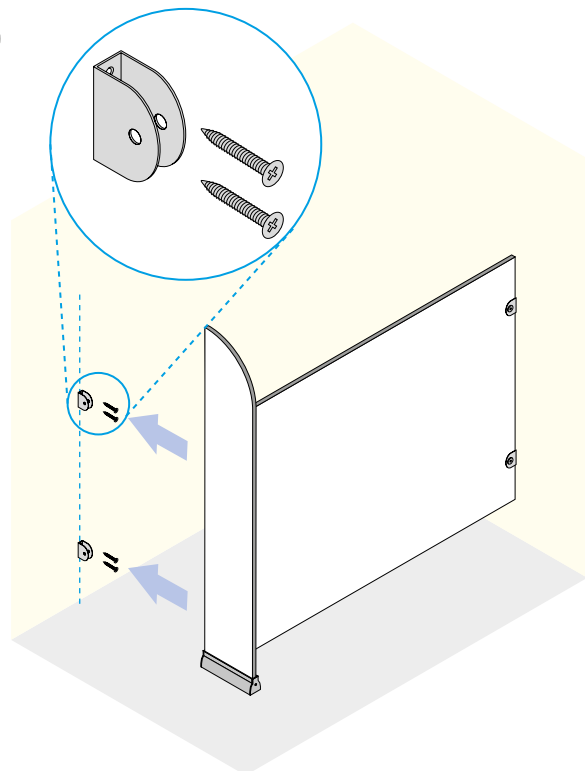

Attach two 'D' brackets to the opposite wall using screws and wall plugs provided. Ensure they are level with the pilaster.

8

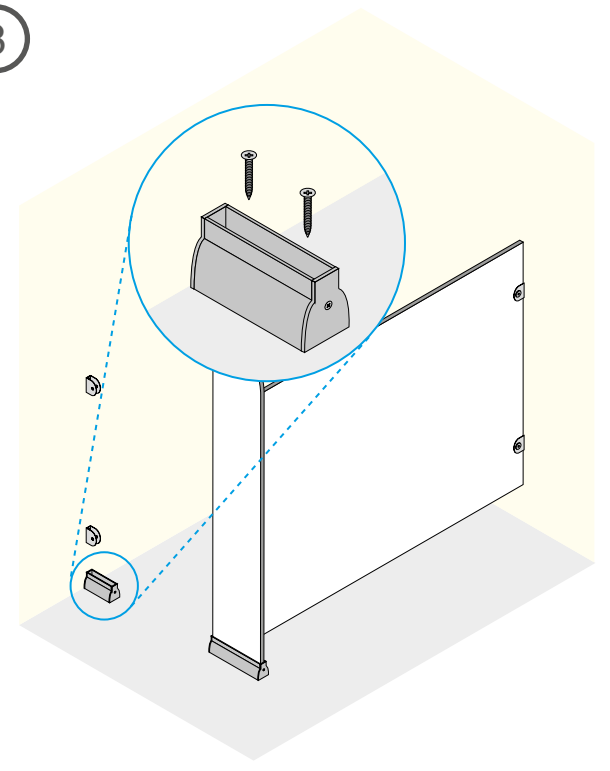

Attach the floor channel level with the other channel.

9

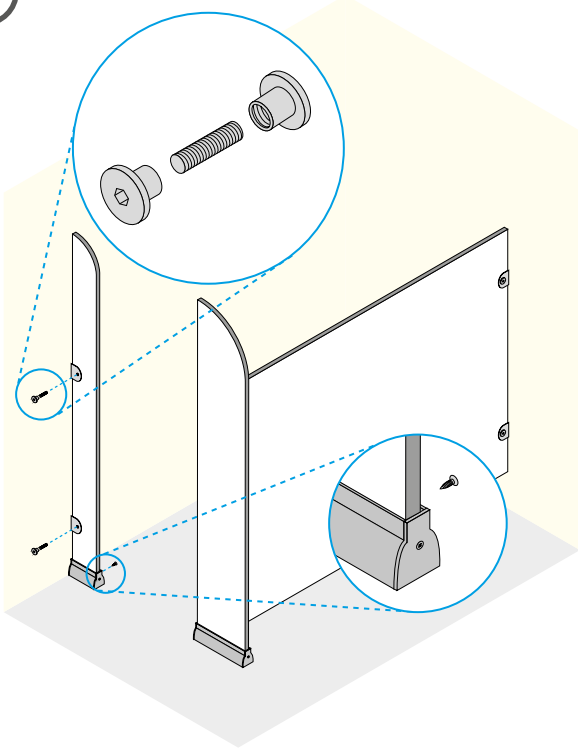

Drill through the partition and secure the pilaster with T-nuts through the 'D' brackets. Secure the pilaster into the channel by screwing through the aluminium into the pilaster with dome-head screws.

10

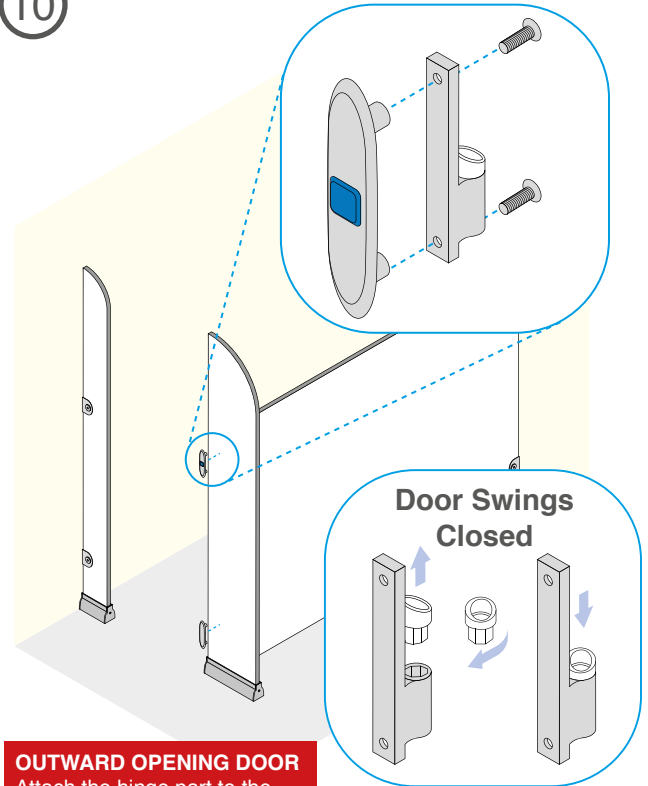

**OUTWARD OPENING DOOR**  
Attach the hinge part to the outer of the pilaster

Separate the hinge parts. Attach the bottom part of the hinge plate to the pilaster via the pre-drilled holes on the pilaster. The door swings open as standard but can be altered to swing closed by rotating the plastic insert as shown.

11

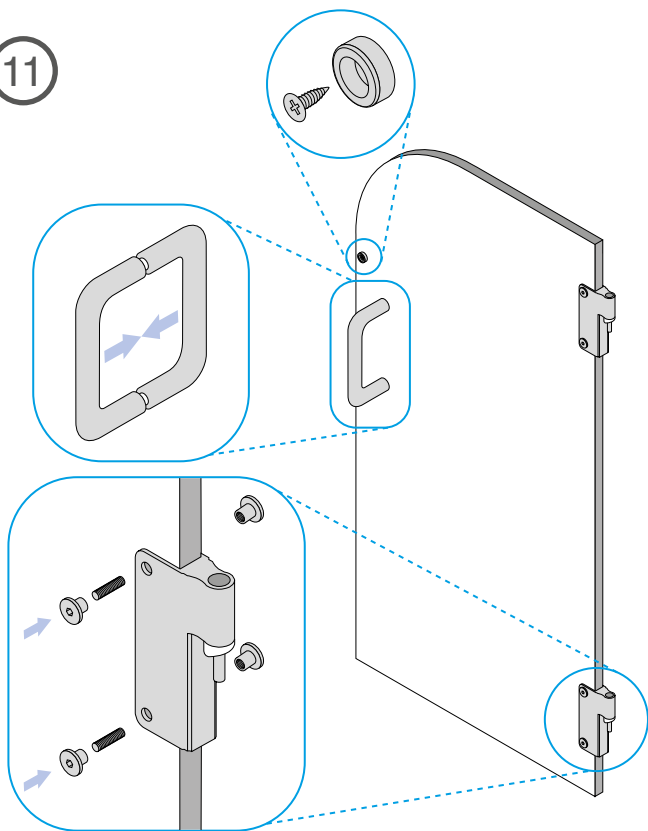

Attach the other part of the hinge to the door with T-nuts via the pre-drilled holes. Drill through the door to attach the handle on either side. Screw the magnet to the edge of the door where it will meet the pilaster. Attach the magnetic door catch to the back of the door for outward opening.

12

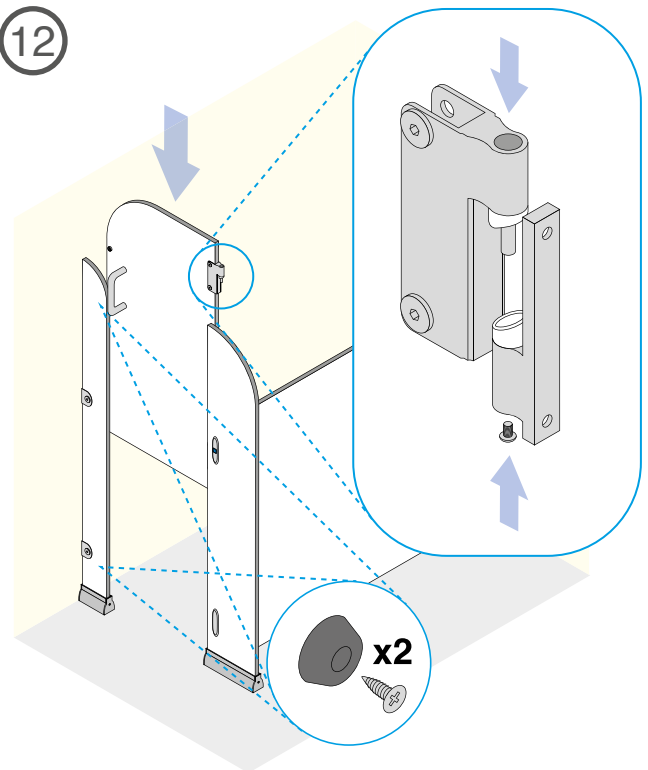

Hang the door by slotting in the hinge parts together making sure the hinge screw is then fitted. Add two rubber buffers to the inside of the pilaster. Ensure the top buffer lines up with the magnet when closed. This will act to keep the door from swinging open.

13

Test the door and magnetic mechanism to make sure it has been assembled correctly.  
Ensure all fixings are secure.

Perform the previous steps to install any other cubicle configurations.

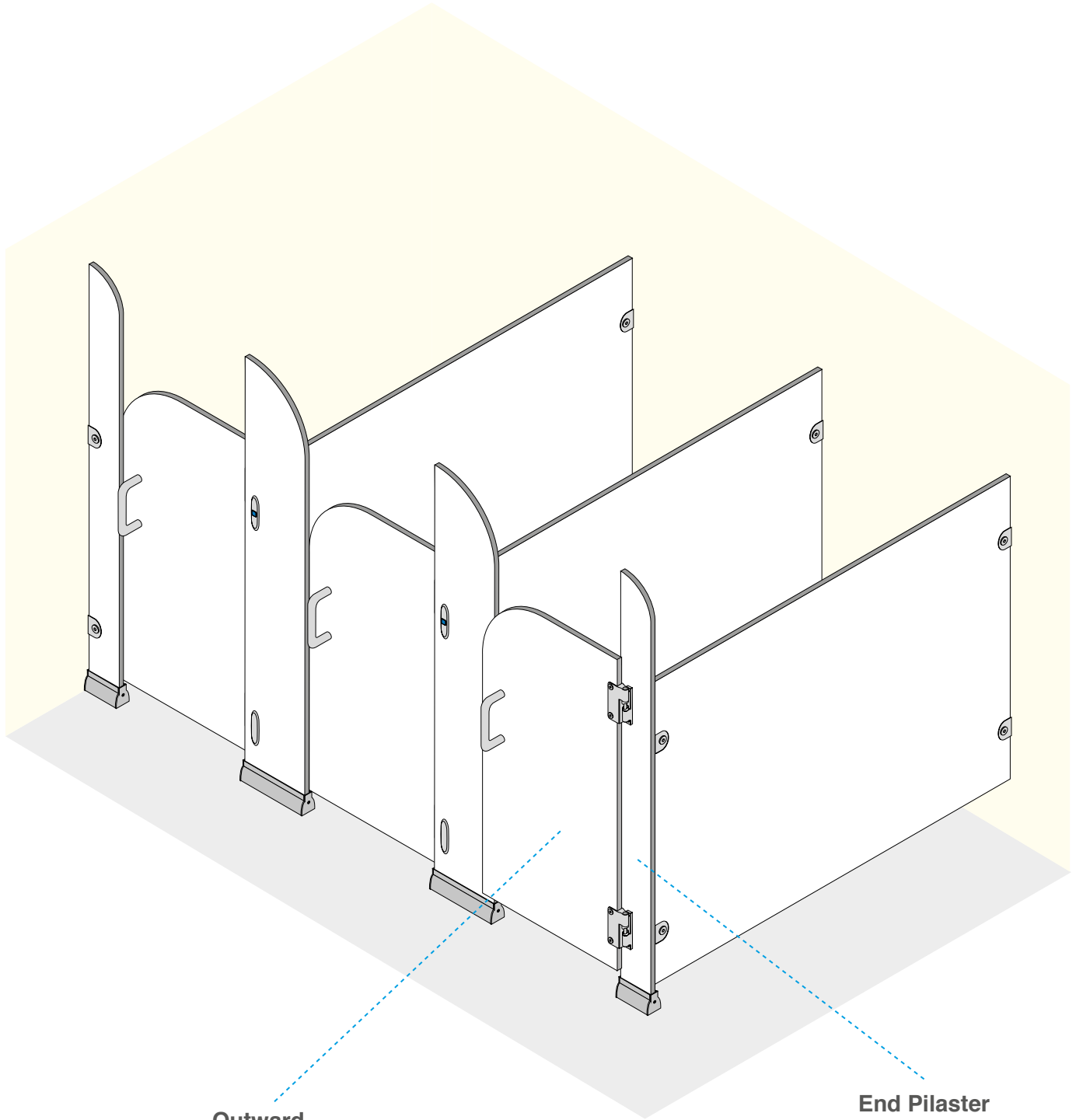

**Outward  
Opening Door**

**End Pilaster**

[www.washroomcubicles.co.uk](http://www.washroomcubicles.co.uk)

© 2015 Cubicle Centre  
Sydney is a UK registered trademark of Cubicle Centre



Full range of sanitary ware available to buy online



Toilet Pans



Basin Taps



Wash Basins



Doc-M Packs



Urinals



Accessories

[plumbware.co.uk](http://plumbware.co.uk)